

PrismXR Puppis S1
P1411
User Manual
Rev1.1
10/25/2023

Support

For more information, please visit www.prismxr.com/pages/support

Contents

1. What's In the Box	1
2. Product Introduction	2
2.1 Product Overview	2
2.2 Panel Layout	4
3. Set Up your Puppis S1	6
3.1 Connect Puppis S1 and PC	6
3.2 Download PrismXR App	9
3.3 Connect to PrismXR App	10
3.4 Reconnect to PrismXR App	13
4. PrismPulse Mode (How to Stream)	15
4.1 Set Up Internet	15
4.2 Start Streaming	17

5. Wi-Fi Hotspot Mode	18
6. Wi-Fi Adapter Mode	20
7. Set Up PC Internet Sharing	21
7.1 Windows 10	21
7.2 Windows 11	25
8. Disable PC Internet Sharing	29
8.1 Windows	29
9. Using PrismXR App	30
9.1 PrismPulse Mode	30
9.2 Wi-Fi Hotspot Mode	35
9.3 Wi-Fi Adapter Mode	40
9.4 Settings	43
9.5 Wi-Fi Setting	44

9.6 DHCP Server	45
10. Maintenance	46
10.1 Firmware Update	46
10.2 Factory Reset	48
11. Specifications	49
12. Safety Instructions	52
13. Warranty	54
14. FCC Statement	55

1. What's In the Box

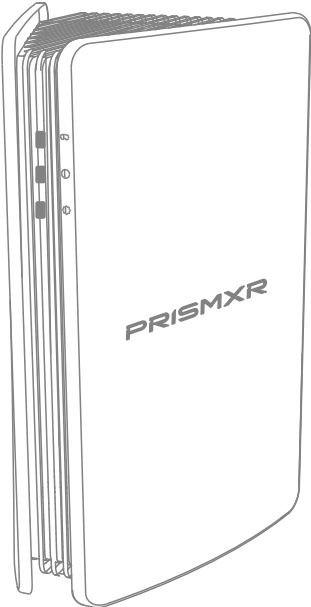

Puppis S1

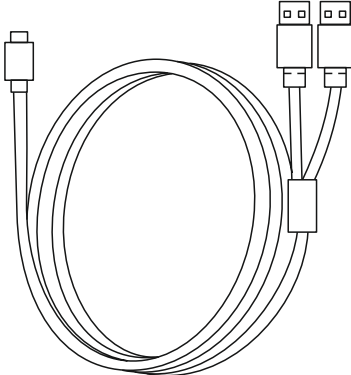

Data Cable

2. Product Introduction

2.1 Product Overview

The PrismXR Puppis S1 is a specialized router designed for enhanced streaming experience between VR headsets and PCs. It utilizes 802.11AX Wi-Fi technology and a dedicated 5G band to ensure a smooth and stable connection. With the Puppis S1, you can enjoy virtual reality experiences with optimized streaming performance, reduced latency, and improved overall performance. Additionally, it supports both 2.4G Wi-Fi and PC Internet Sharing, providing flexibility in how you connect to the internet. Puppis S1 supports three modes: PrismPulse, Wi-Fi Hotspot, and Wi-Fi Adapter.

- ① PrismPulse Mode(default): Establish a high-speed, dedicated connection between your PC and HMD.
- ! Only one HMD can be connected at a time.

- ② **Wi-Fi Hotspot Mode:** Function as an access point, establishing a Local Area Network (LAN) for PCs and other wireless devices.
- ❗ A maximum of 16 devices can be connected simultaneously, with support for 8 devices on both 2.4GHz and 5GHz hotspots.
- ③ **Wi-Fi Adapter Mode:** Function as a client to enable your PC to connect to the Internet.

You can download the PrismXR App to enhance your experience, including mode switching, upload or download rate, network monitoring, Wi-Fi settings, device management, firmware updating, and more.

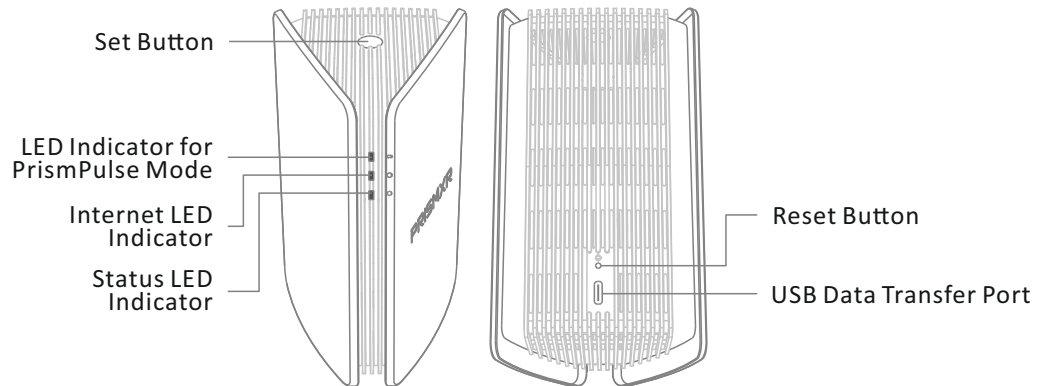

2.2 LED Indicators and Buttons

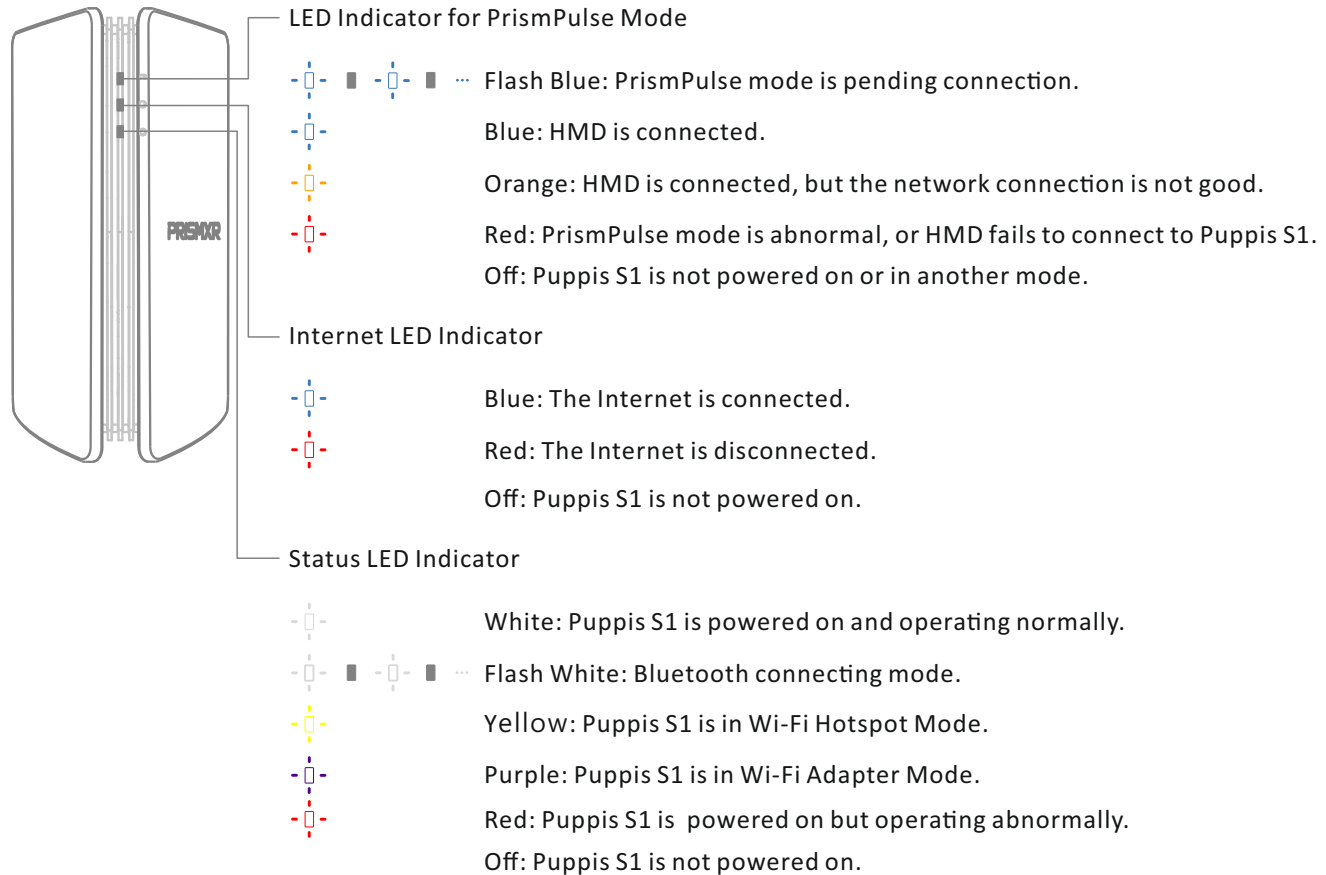

- Press once to reconnect your Puppis S1 to the PrismXR App.
- Press and hold the button for more than 3 seconds to switch modes: PrismPulse Mode > Wi-Fi Hotspot Mode > Wi-Fi Adapter Mode.
- Press and hold the button for 10 seconds to re-enter pairing mode.

Set Button

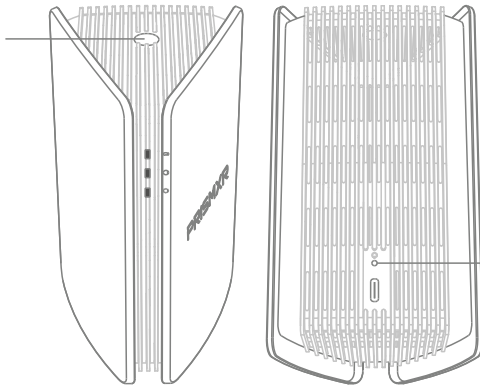

Reset Button

- Press and hold the button for approximately 5 seconds until the All LED Indicators blink red five times to reset the router to its factory default settings.

3. Set Up your Puppis S1

3.1 Connect Puppis S1 and PC

ⓘ It will take about 30 seconds for the Puppis S1 to boot up.

Requirements:

- Your PC should have two USB-A 3.0 ports, or one USB-A 3.0 port and one USB-A 2.0 port. Alternatively, you can use a USB 3.0 C-C data transfer cable (not provided).
- Please insert the provided USB cable into the corresponding ports on your PC. Plugging in the cable in reverse can result in slower data transfer speeds.

① Insert the blue-marked male USB-A into the USB-A 3.0 port on the PC, and insert the white-marked male USB-A into another USB-A 3.0 or USB-A 2.0 port on the PC.

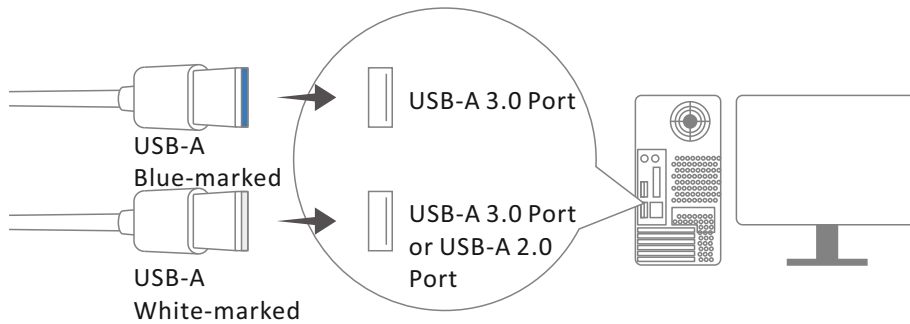

- 2 Position the side of the male USB-C connector labeled "L" to the left, and the side labeled "R" to the right, then insert it into the Puppis S1.

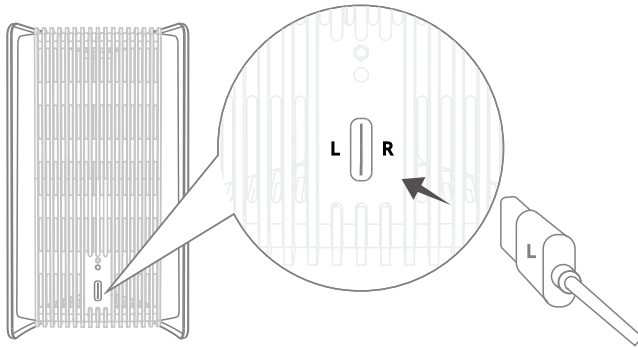

- 3 The Puppis S1 will perform as follows after it has finished booting:
 - a Enter pending HMD and Bluetooth pairing mode with LED Indicator for PrismPulse Mode flashes blue and Status LED Indicator flashes White.
 - b The Internet LED Indicator is red due to the device not being connected to the network.

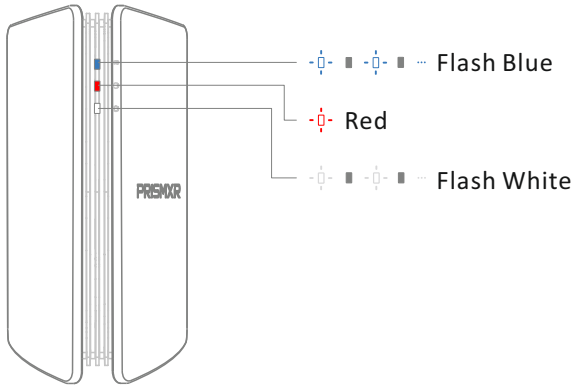

3.2 Download PrismXR App

- Get and download the PrismXR App on the Apple App Store or Google Play.



App Store and App Store logo are trademarks of Apple Inc.



Google Play and the Google Play logo are trademarks of Google LLC.

3.3 Connect to PrismXR App

- ❗ PrismPulse mode only supports internet access under 2.4GHz networks.
- ❗ If the status LED indicator stops flashing white, press and hold the SET button for 10 seconds to enter Bluetooth pairing mode.
- ❶ Make sure your Puppis S1 is in Bluetooth pairing mode with the status LED indicator flashes white.

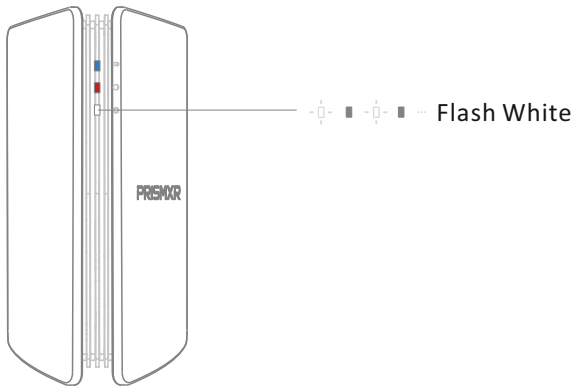

- ② Open the PrismXR App, there will be a pop-up notification saying "Puppis S1 is Found".
- ③ Select "Add" to add the Puppis S1 to the App.
- ④ The App will automatically go to the device initialization process after the Puppis S1 is added.
 - Ⓐ On the "Wi-Fi Setting" page, click on "Wi-Fi Setting" to search and connect your Puppis S1 to a 2.4GHz Wi-Fi network. The Puppis S1's Internet LED indicator will turn blue.
 - Ⓑ After the Wi-Fi setup is completed, the app will automatically go to the "Update Available" page if there is a new firmware available, you can follow the instructions in **Section 10.1** to update firmware.
 - Ⓒ When the firmware update is completed or when there is no firmware update available, the App will automatically go to the introduction of the three modes of Puppis S1, instructions on

how to re-connect Bluetooth, and instructions on how to switch modes.

- d Click "Got It" or "<" in the top left corner to exit the device initialization process.
- 5 After the device initialization is complete, you can now use your Puppis S1 in the App.

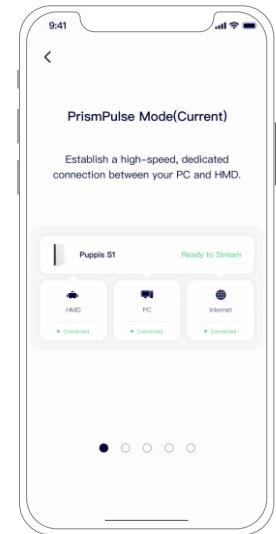
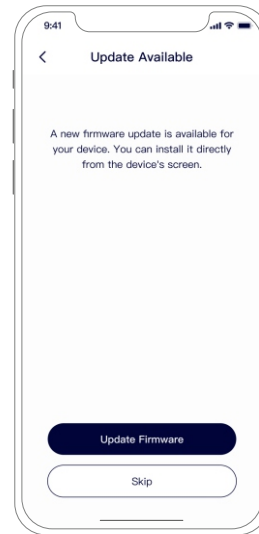
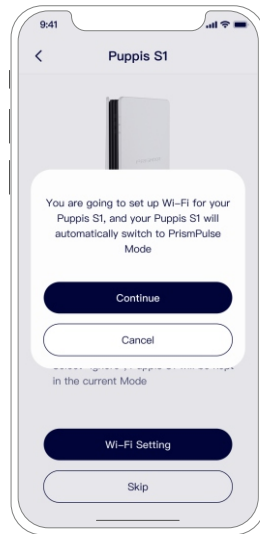
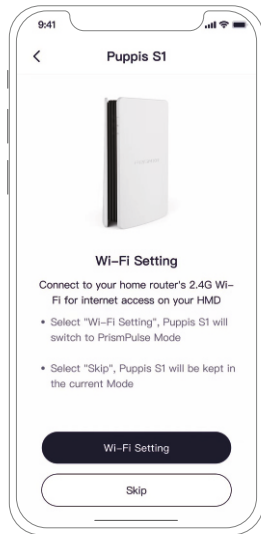
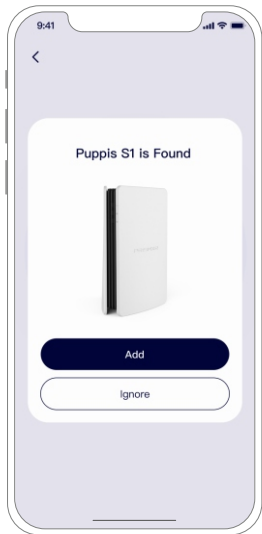

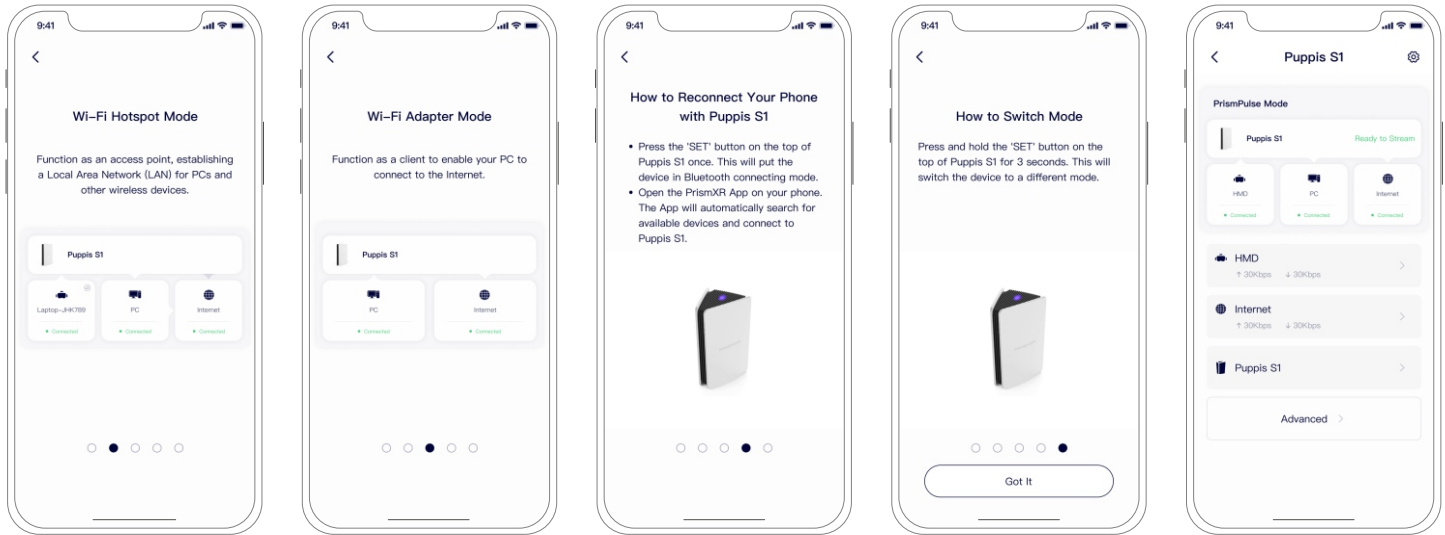

3.4 Reconnect to PrismXR App

To ensure maximum smoothness of PC VR streaming, the Bluetooth connection between the app and the Puppis S1 is not always maintained. Instead, it automatically disconnects after 30 minutes when the App is exited and running in the background. You can follow the steps below to reconnect the Puppis S1 to the App.

- 1 Open the PrismXR App.
- 2 Press the SET button on the Puppis S1 once, and the Puppis S1 will enter pairing mode.
- 3 Your Puppis S1 will automatically reconnect to the PrismXR App.

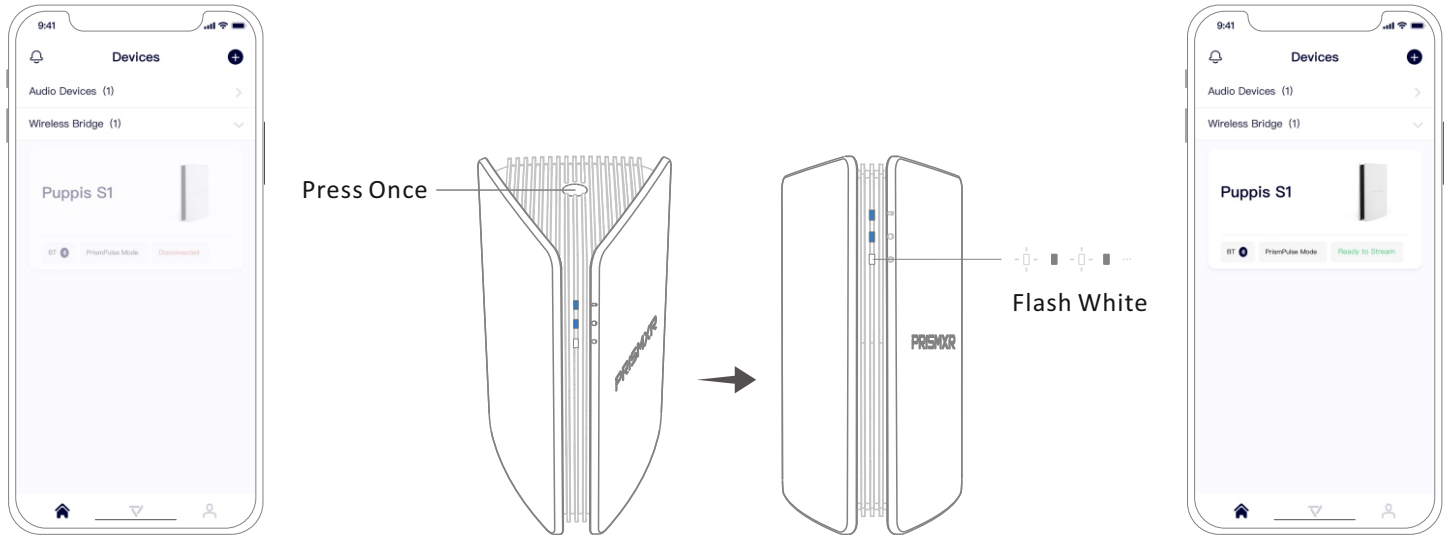

4. PrismPulse Mode (How to Stream)

4.1 Set Up Internet

- ❗ When Puppis S1 is not connected to the Internet, you can use the Puppis S1 for PC VR streaming, but the streaming data cannot be saved and synchronized to the cloud.

You can choose one of the following three methods to set up the Internet for Puppis S1 before streaming.

- Method 1: Connect Puppis S1 to the Internet via 2.4G Wi-Fi.
 - Method 2: Connect Puppis S1 to the Internet via PC Internet Sharing. If your PC's Internet sharing is disabled, you can follow the instructions in **Section 7** to enable PC Internet Sharing.
- ❗ When you switch the network connection mode of your Puppis S1 between PC Internet Sharing and Wi-Fi connection, please note the following:

- ❗ Temporary Network Interruption: Due to Windows-related reasons, there will be a brief 30-second period during which the network of Puppis S1 can not be accessed. This is a normal occurrence during the switching. Windows needs this time to re-detect and establish the new network connection.
- ❗ Puppis S1 Internet LED Indicator: While the network is temporarily unavailable, the Internet LED indicator on Puppis S1 will turn red. Once the network connection is re-established, the LED indicator will return to blue.

4.2 Start Streaming

- 1 Turn on your PC and VR headset.
- 2 Select "PrismPulse" in the Wi-Fi settings of your VR headset.
- 3 Depending on your VR headset, you can choose your preferred streaming method, such as Virtual Desktop(recommended), Quest Link, Pico Streaming Assistant, etc.
- 4 Follow the streaming method interface to select the operation you want to perform.

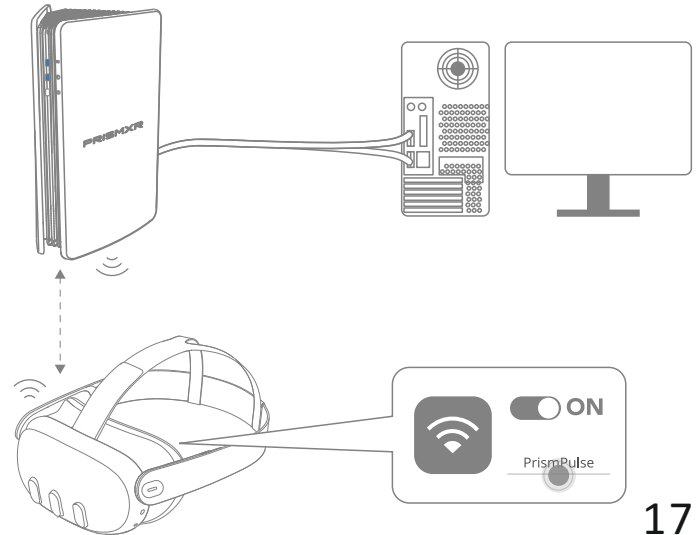

5. Wi-Fi Hotspot Mode

- ❗ If your PC's Internet sharing is disabled, you can follow the instructions in **Section 7** to enable PC Internet Sharing.
- ❗ When you switch the network connection mode of your Puppis S1 between PC Internet Sharing and Wi-Fi connection, please note the following:
 - ❗ **Temporary Network Interruption:** Due to Windows-related reasons, there will be a brief 30-second period during which the network of Puppis S1 can not be accessed. This is a normal occurrence during the switching. Windows needs this time to re-detect and establish the new network connection.
 - ❗ **Puppis S1 Internet LED Indicator:** While the network is temporarily unavailable, the Internet LED indicator on Puppis S1 will turn red. Once the network connection is re-established, the LED indicator will return to blue.

- 1 Enable PC Internet sharing.
- 2 On the Settings page of the PrismXR App or by pressing and holding the SET button on the device for 3 seconds until the status LED indicator turns yellow (by using the SET button, depending on your current mode, you may need to press and hold the button for 3 seconds 1-2 times), which indicates that the Puppis is switched to Wi-Fi Hotspot mode.
- 3 Select "PrismXR Hotspot" or "PrismXR Hotspot_5G" in the Wi-Fi settings of your device.

- 4 Now you can enjoy the hotspot to connect your device to the internet.

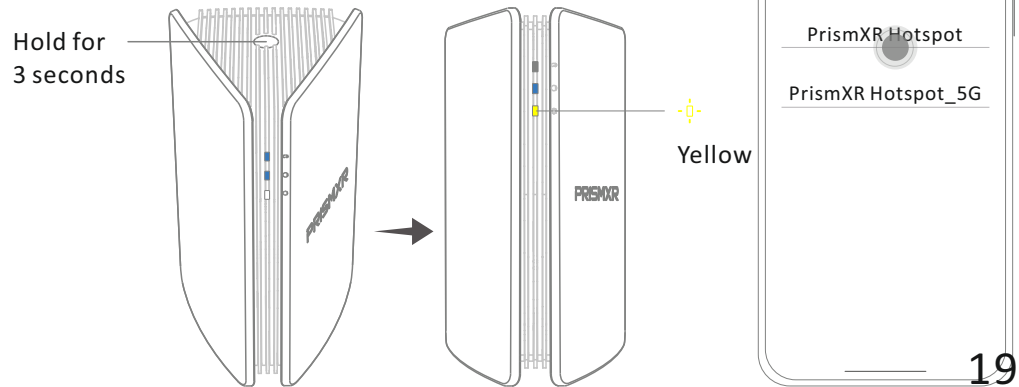

6. Wi-Fi Adapter Mode

- ❗ If your PC's Internet sharing is enabled, you can follow the instructions in **Section 8** to disable PC Internet Sharing.
- 1 Disable PC Internet sharing.
 - 2 On the Settings page of the PrismXR App or by pressing and holding the SET button on the device for 3 seconds until the status LED indicator turns purple (by using the SET button, depending on your current mode, you may need to press and hold the button for 3 seconds 1-2 times), which indicates that the Puppis is switched to Wi-Fi Adapter mode.
 - 3 Now you can enjoy the wireless network to connect your PC to your Puppis S1's Internet.

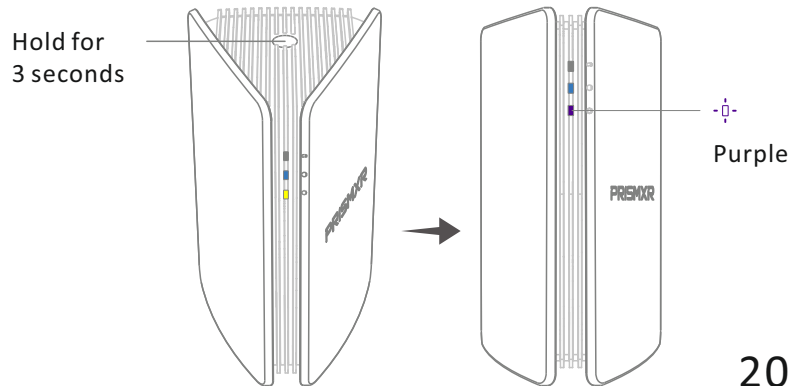

7. Set Up PC Internet Sharing

7.1 Windows 10

- 1 Right-click the network icon (Ethernet or WiFi) and select "Open Network & Internet Settings," then click "Change Adapter Options" to access "Network Connections" settings.
- ! Alternatively, navigate to the next step via "Windows Settings" > "Network & Internet" > "Change Adapter Options".

a

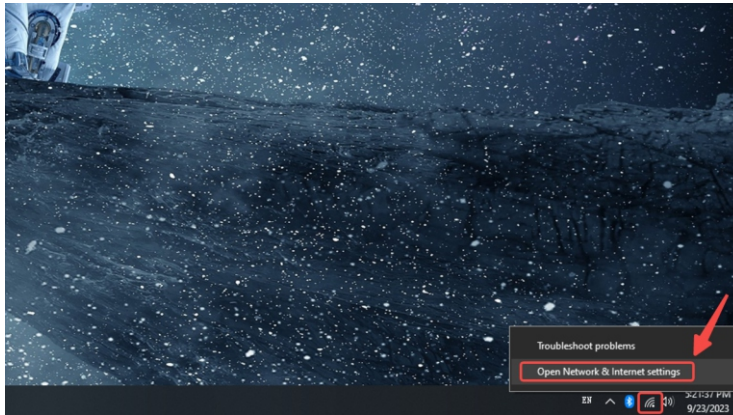

b-1

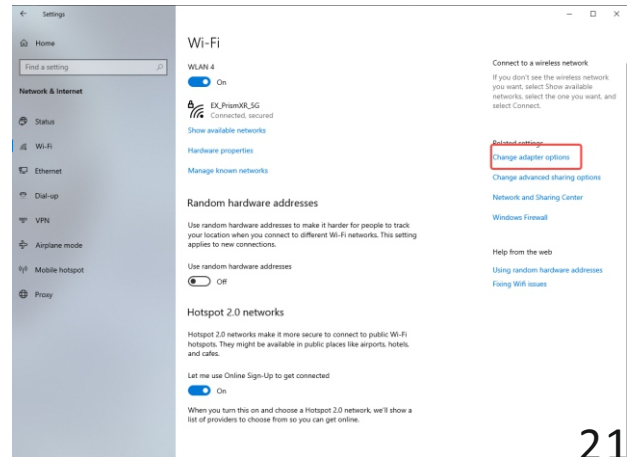

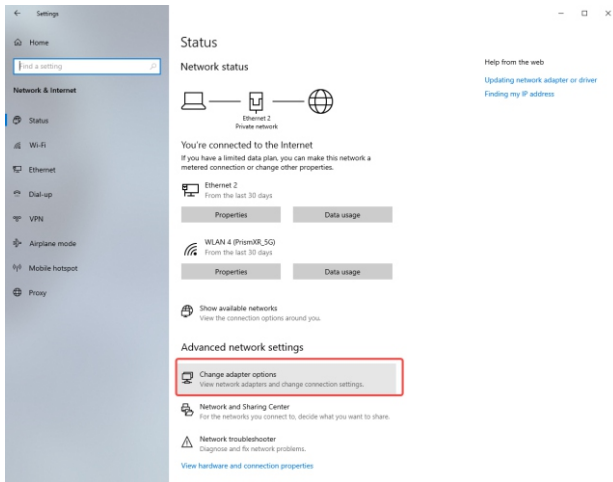

- ② Identify the internet connection you wish to share with Puppis S1.
- ❗ The Ethernet labeled "ASIX AX88179 USB3.0..." denotes the connected Puppis S1.



- 3 Right-click the desired network for sharing with Puppis S1, select "Properties", and navigate to the "Sharing" tab within the Properties window.

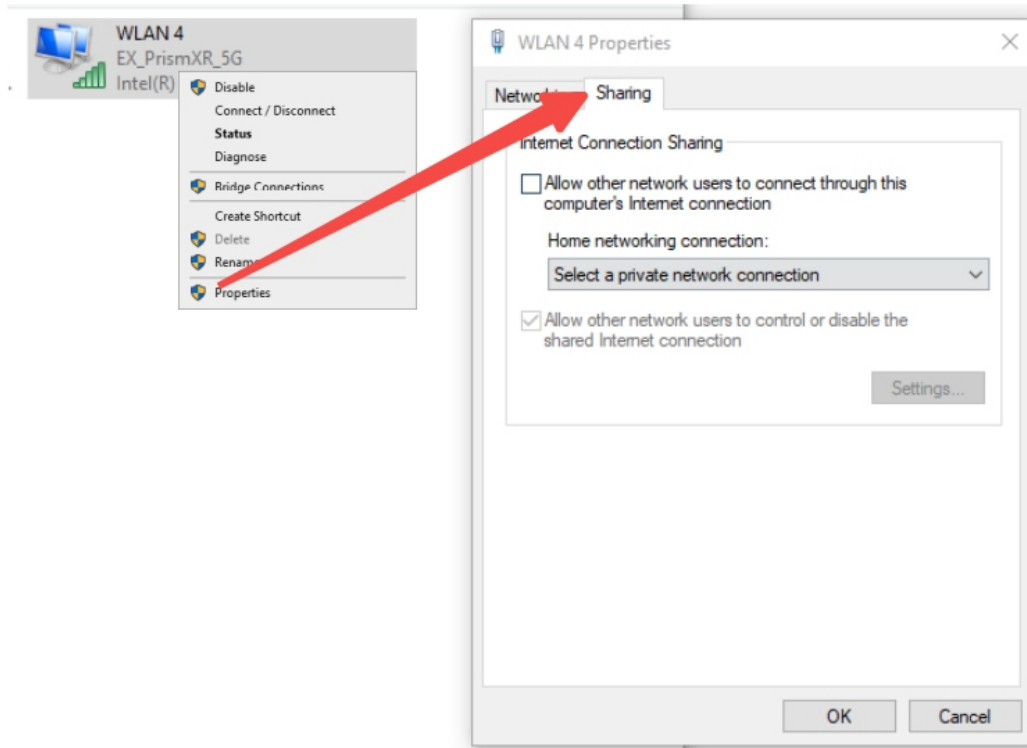

- 4 Check the first box ("Allow other network users to connect...") and then select the connection from Puppis S1, as identified in step 2.
- ! In some systems, options under "Home Networking Connection" may be absent. If this occurs, there's no need to select one for Puppis S1; the internet will be shared automatically.

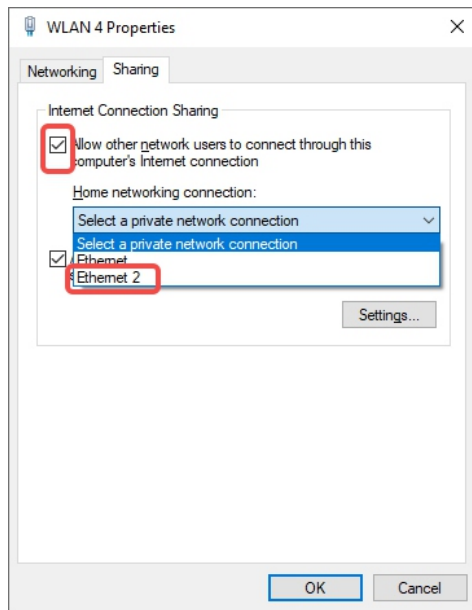

7.2 Windows 11

- 1 Right-click the network icon (Ethernet or WiFi) and select "Open Network & Internet Settings". Click "Advanced network settings", then click "More network adapter options" to access "Network Connections" settings.
- ! Alternatively, navigate to the next step via "Windows Settings" > "Network & Internet" > "Advanced network settings" > "More network adapter options".

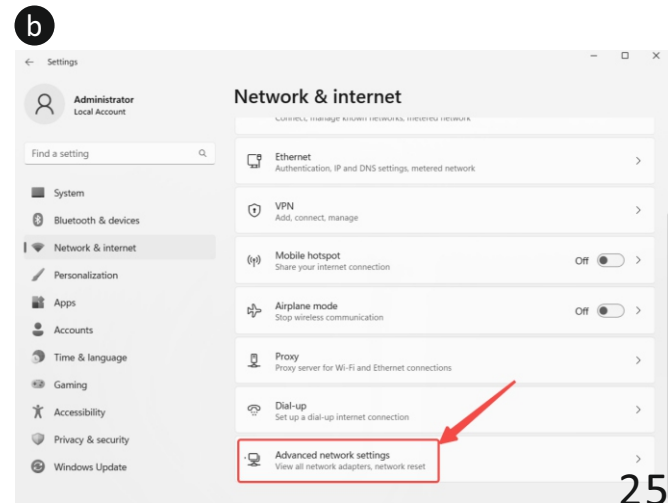
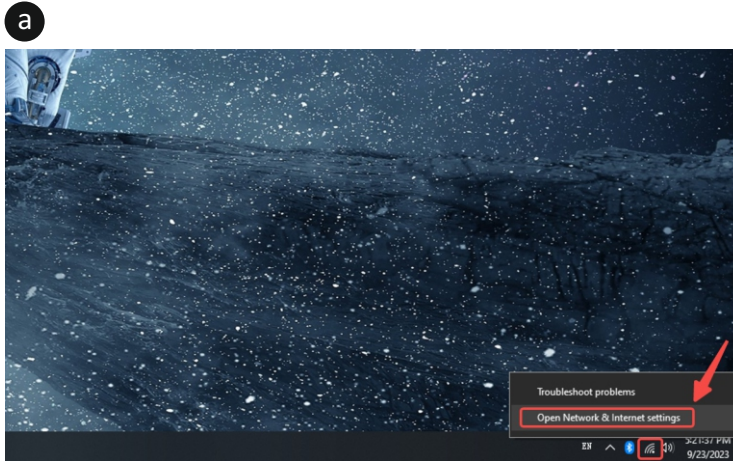

C

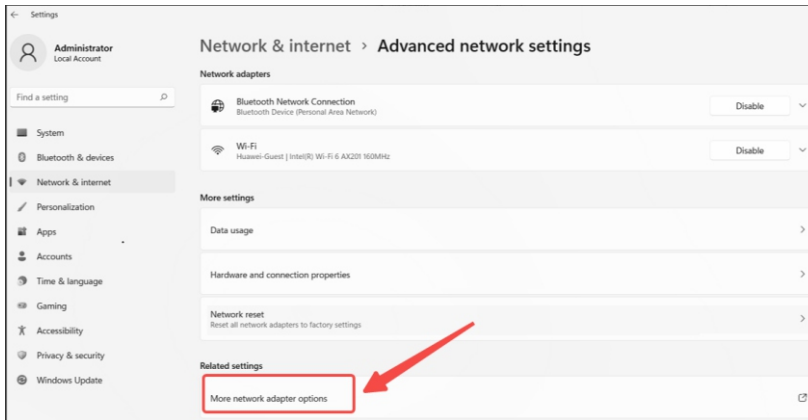

2 Identify the internet connection you wish to share with Puppis S1.

! The Ethernet labeled "ASIX AX88179 USB3.0..." denotes the connected Puppis S1.



- 3 Right-click the desired network for sharing with Puppis S1, select "Properties", and navigate to the "Sharing" tab within the Properties window.

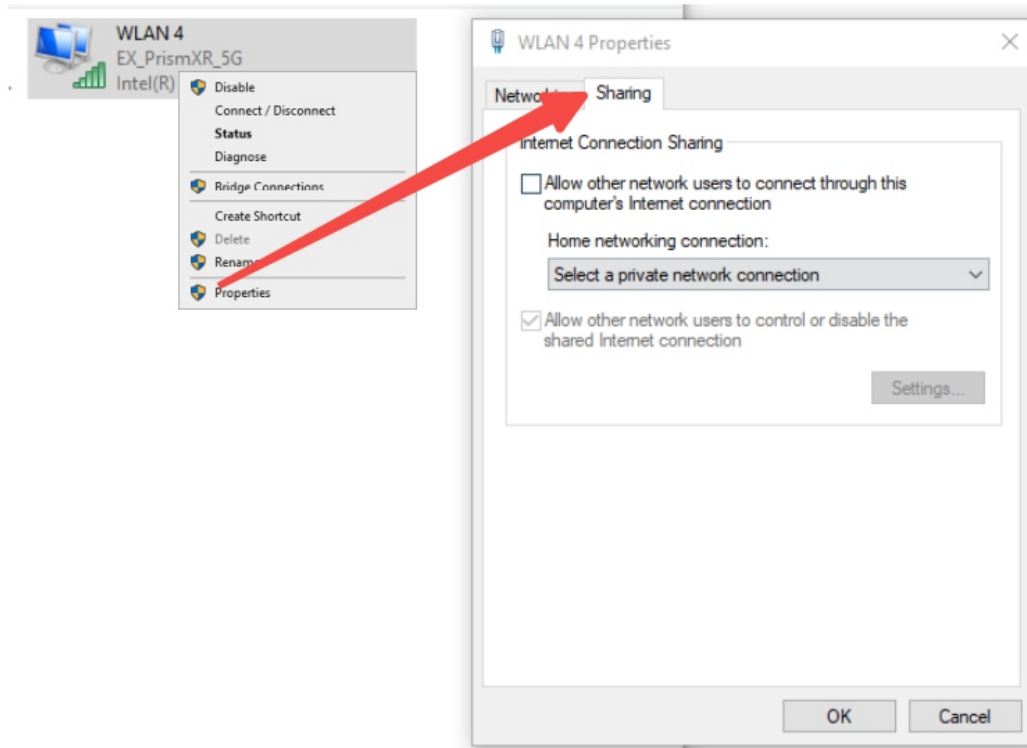

- 4 Check the first box ("Allow other network users to connect...") and then select the connection from Puppis S1, as identified in step 2.
- ! In some systems, options under "Home Networking Connection" may be absent. If this occurs, there's no need to select one for Puppis S1; the internet will be shared automatically.

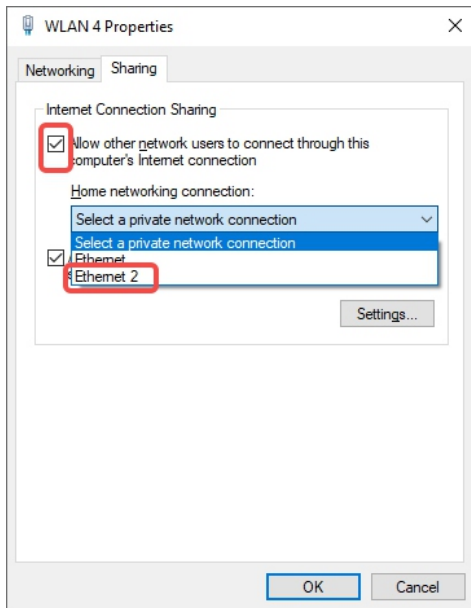

8. Disable PC Internet Sharing

8.1 Windows

- ① Repeat the step from the previous section (**Section 7**) and navigate to the Properties of the Network for which you want to disable sharing.
- ② Uncheck the first box ("Allow other network users to connect...").
- ③ Click "OK," and it's all set.

9. Using PrismXR App

9.1 PrismPulse Mode

9.1.1 Details Page

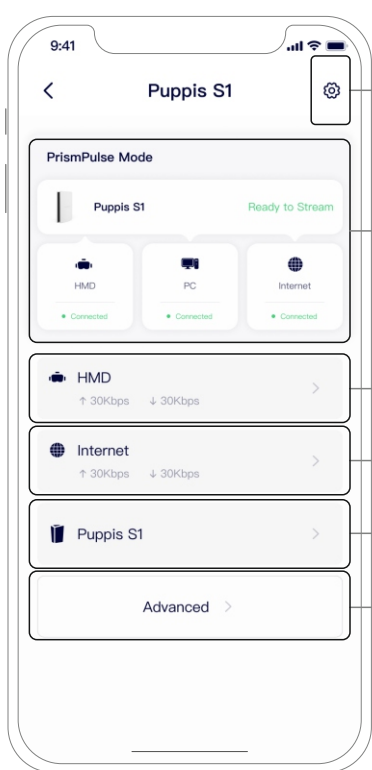

9:41

Puppis S1

PrismPulse Mode

Puppis S1 Ready to Stream

HMD PC Internet

Connected Connected Connected

HMD
↑ 30Kbps ↓ 30Kbps

Internet
↑ 30Kbps ↓ 30Kbps

Puppis S1

Advanced

Click to enter the Settings page.

Network Topology Diagram

- Current status of PrismPulse Mode: Ready to Stream, Unable to Stream, Disconnected.
- Connection status of Puppis S1 with HMD(Head-Mounted Display), PC and Internet: Connected or Disconnected.

Display the HMD name and HMD's upload or download speed, click to enter the HMD Settings page.

Display the upload or download speed the Internet the Puppis S1 is connected to, click to enter the Internet Settings page.

Click to enter the Puppis S1 Settings page.

Click to enter the Advanced page.

9.1.2 HMD(Head-Mounted Display) Settings

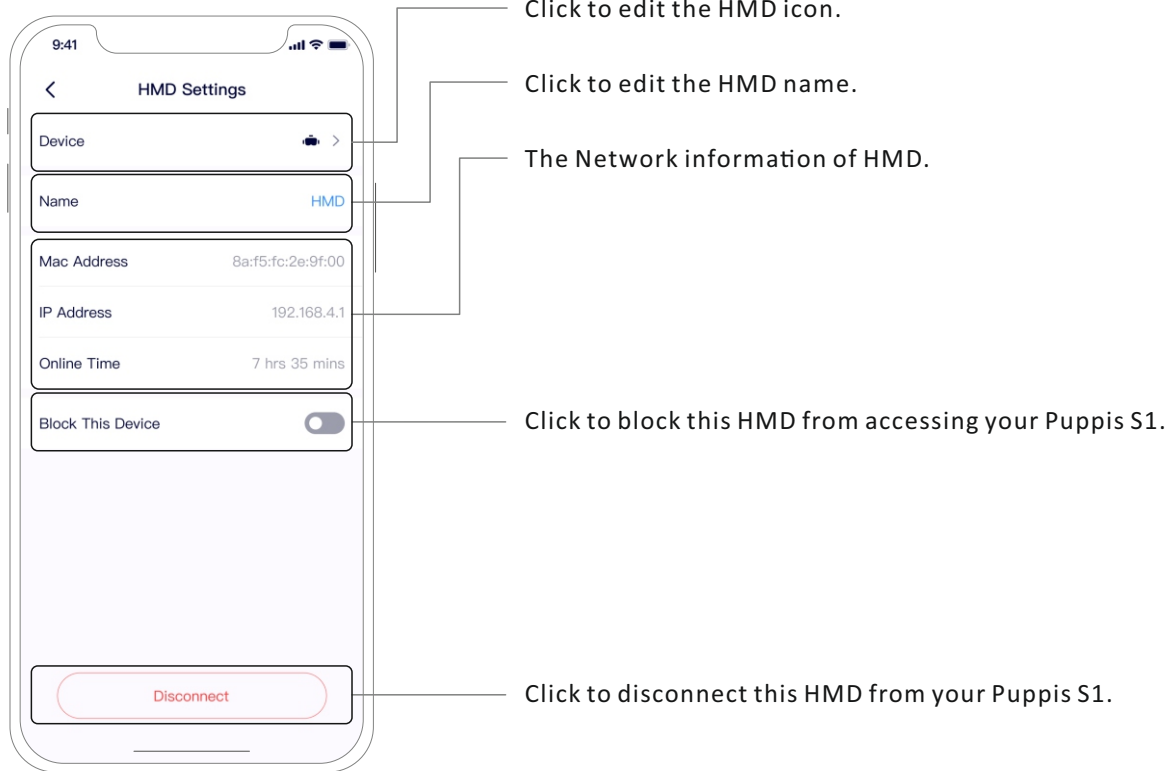

9.1.3 Internet Settings

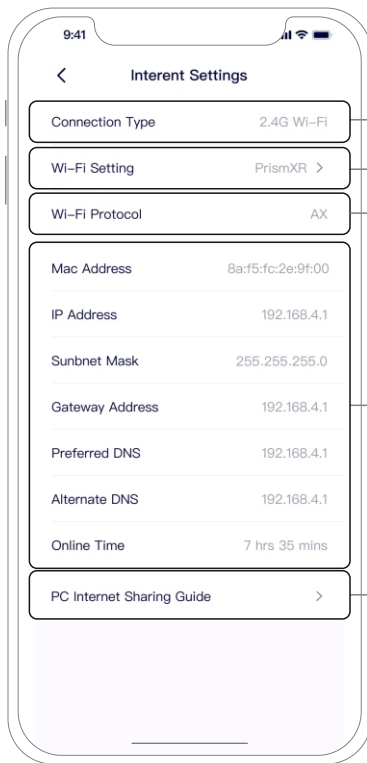

The connection status of Puppis S1 is connected to the Internet: 2.4G Wi-Fi, PC Internet Sharing, Disconnected.

Click to configure Wi-Fi for Puppis S1. (Only available when Puppis S1 is connected to Internet via 2.4G Wi-Fi or when Puppis S1 is disconnected to Internet.) You can follow the instructions in **Section 11.5** for more information.

Automatically synchronize the Wi-Fi protocol of the current Wi-Fi the Puppis S1 is connected to.

The Internet information of the PC or router the Puppis S1 is connected to.

Click to go to PC Internet Sharing Guide.

9.1.4 Puppis S1 Settings

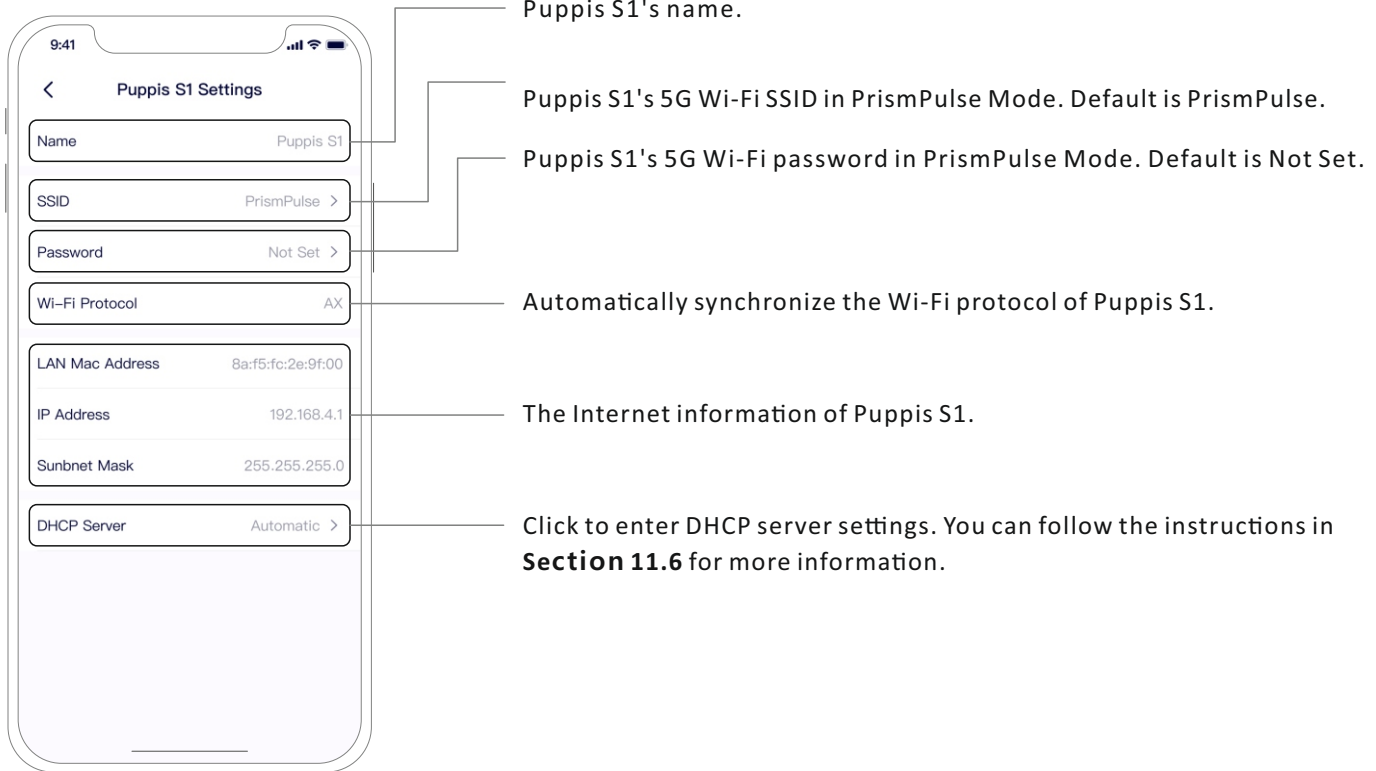

9.1.5 Advanced

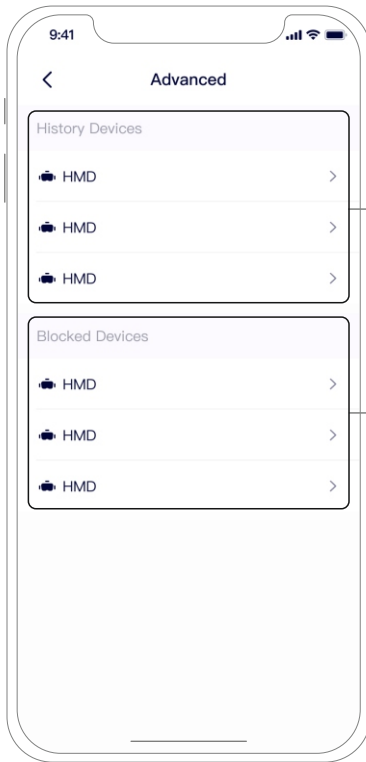

History device list of HMD(s) that are connected to your Puppis S1. You can edit the device icon, device name, block the HMD, or view the HMD's Mac address.

Blocked device list of HMD(s) that are block from accessing your Puppis S1. You can remove the blocked HMD(s) from the blocked list.

9.2 Wi-Fi Hotspot Mode

9.2.1 Details Page

Click to enter the Settings page.

Network Topology Diagram

- Connection status of Puppis S1 with device(s), PC and Internet: Connected, Disconnected.
- When there are two or more devices, an icon for additional devices will be displayed in the top right corner of the device. Clicking on it will expand or fold out more devices.

Display the device's name and device's upload or download speed, click to enter the device's Settings page.

Display the upload or download speed the Internet the Puppis S1 is connected to, click to enter the Internet Settings page.

Click to enter the Puppis S1 Settings page.

Click to enter the Blocked Devices page.

9.2.2 Device Settings

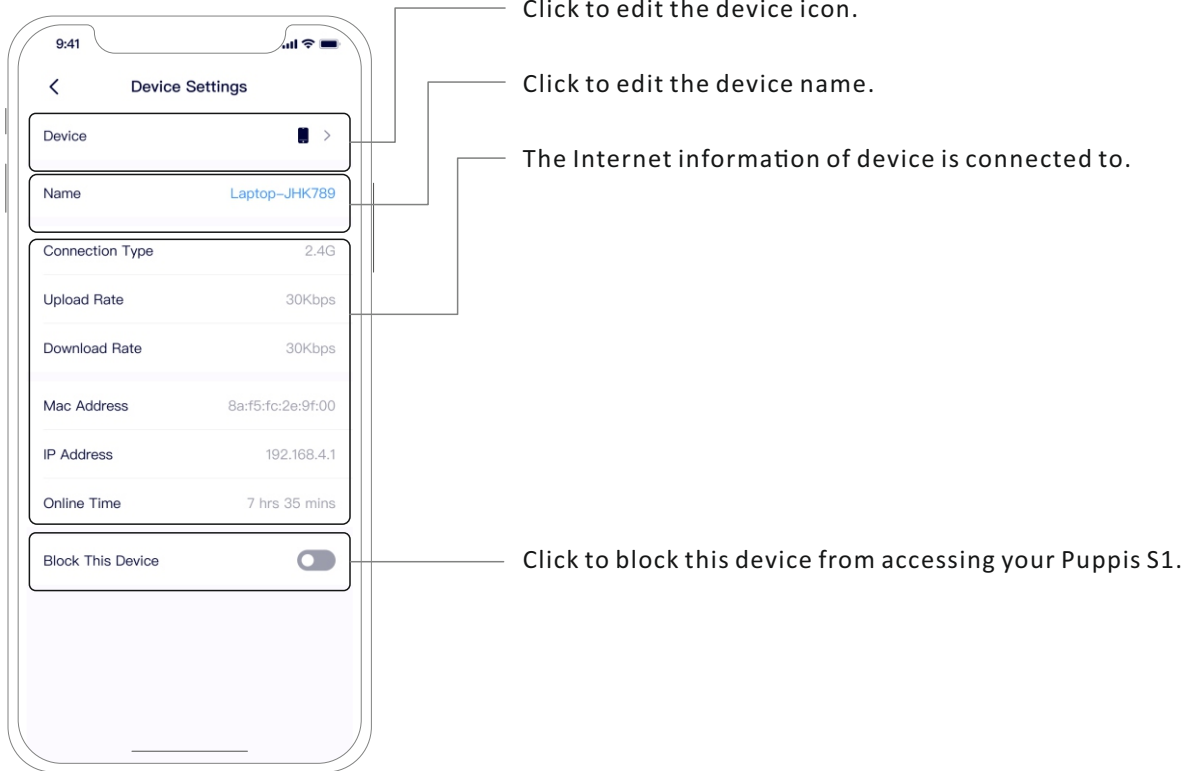

9.2.3 Internet Settings

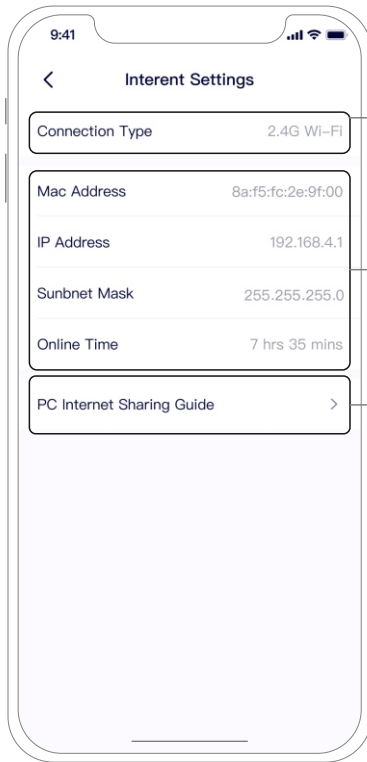

The connection status of Puppis S1 is connected to the Internet: PC Internet Sharing, Disconnected.

The Internet information of the PC the Puppis S1 is connected to.

Click to go to PC Internet Sharing Guide.

9.2.4 Puppis S1 Settings

Puppis S1's name.

Click to enable or disable 2.4G Wi-Fi hotspot.

Puppis S1's 2.4G Wi-Fi SSID in Wi-Fi Hotspot Mode. Default is PrismXR Hotspot.

Puppis S1's 2.4G Wi-Fi password in Wi-Fi Hotspot Mode. Default is Not Set.

Click to enable or disable 5G Wi-Fi hotspot.

Puppis S1's 5G Wi-Fi SSID in Wi-Fi Hotspot Mode. Default is PrismXR Hotspot_5G.

Puppis S1's 5G Wi-Fi password in Wi-Fi Hotspot Mode. Default is Not Set.

Click to select a protocol for the Puppis S1 hotspot: AX or AC, default is AX.

The Internet information of Puppis S1.

Click to enter DHCP server settings. You can follow the instructions in **Section 11.6** for more information.

9.2.5 Blocked Devices



Blocked device list that are block from accessing your Puppis S1. You can remove the blocked device(s) from the blocked list.

9.3 Wi-Fi Adapter Mode

9.3.1 Details Page

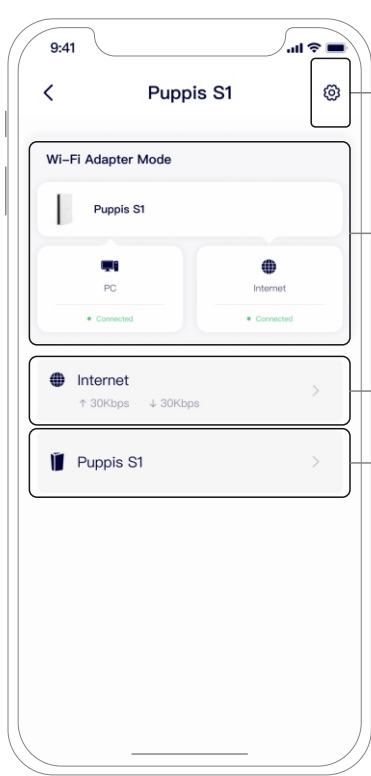

Click to enter the Settings page.

Network Topology Diagram

- Connection status of Puppis S1 with PC and Internet: Connected or Disconnected.

Display the upload or download speed the Internet the Puppis S1 is connected to, click to enter the Internet Settings page.

Click to enter the Puppis S1 Settings page.

9.3.2 Internet Settings

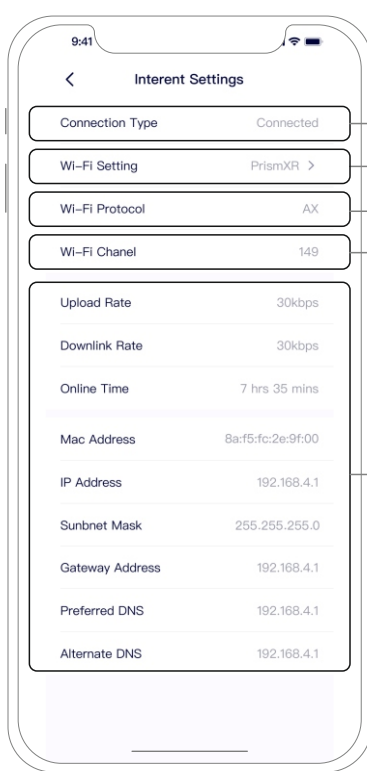

The connection status of Puppis S1, whether the Internet is: Connected, Disconnected.

Click to configure Wi-Fi for Puppis S1. (Only available when Puppis S1 is connected to Internet via 2.4G Wi-Fi or when Puppis S1 is disconnected to Internet.) You can follow the instructions in **Section 11.5** for more information.

Automatically synchronize the Wi-Fi protocol of the current Wi-Fi the Puppis S1 is connected to.

The channel of the current Wi-Fi the Puppis S1 is connected to.

The Internet information of the router the Puppis S1 is connected to.

9.3.3 Puppis S1 Settings

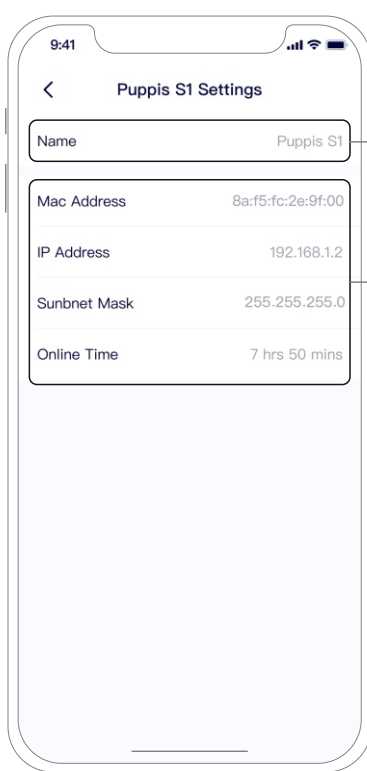

Puppis S1's name.

The Internet information of the PC or router the Puppis S1 is connected to.

9.4 Settings

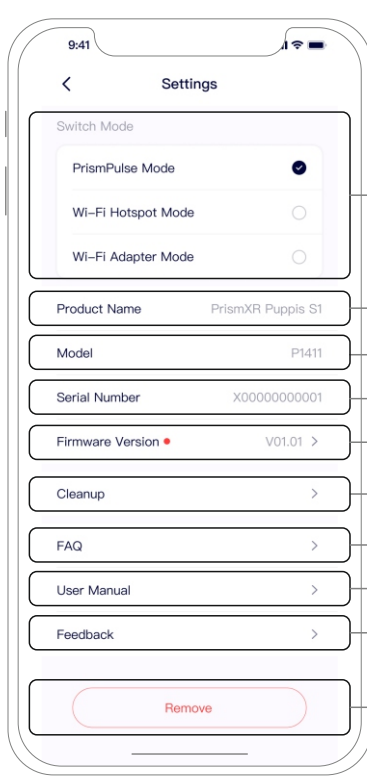

Click on the radio button corresponding to the desired mode to switch to another mode.

Puppis S1's name.

Puppis S1's model number.

The device's serial number.

The firmware version of the device (There will be a red dot if a new firmware version is available).

Click to go to the manual cleanup page.

Click to go to Puppis S1's FAQ.

Click to go to Puppis S1's User Manual.

Click to go to Feedback page.

Click to remove Puppis S1 from your App.

9.5 Wi-Fi Setting

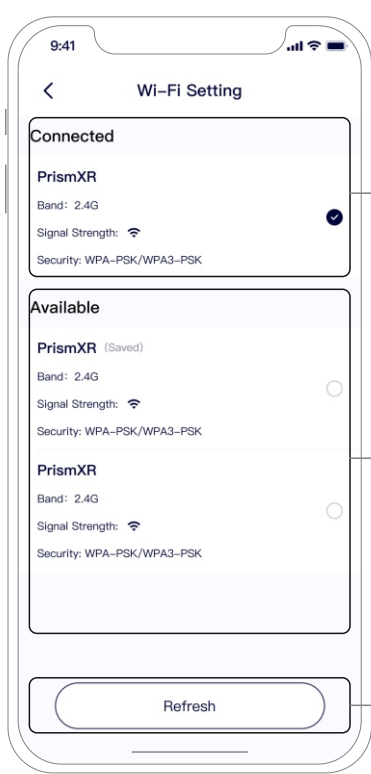

The Wi-Fi that is currently connected to.

Display all the available Wi-Fi list.

Click to refresh the available Wi-Fi list.

9.6 DHCP Server

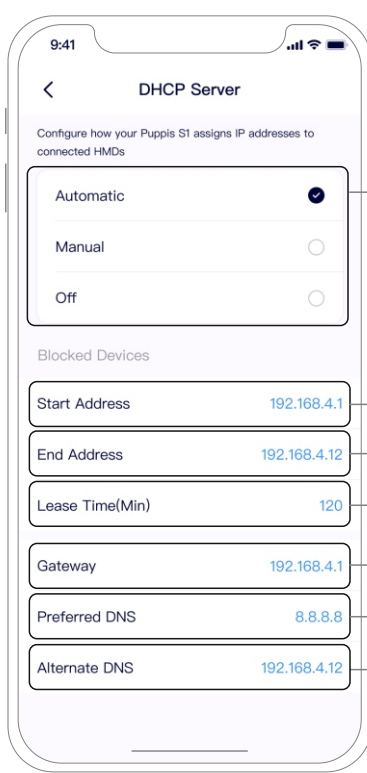

The DHCP Server supports three status settings: automatically, manual, off.

- Default is automatically.
- If DHCP is off, you must have another DHCP server within your network or else you must configure the computer manually.

Specify an IP address for the DHCP Server to start with when assigning IP addresses. 192.168.0.100 is the default start address.

Specify an IP address for the DHCP Server to end with when assigning IP addresses. 192.168.0.199 is the default end address.

The Address Lease Time is the amount of time a network user will be allowed to connect to the router with the current dynamic IP Address. When time is up, the user will be automatically assigned a new dynamic IP address. The range of the time is 1 ~ 2880 minutes. The default value is 120.

It is suggested to input the IP address of the LAN port of the router. The default value is 192.168.0.1.

Input the DNS IP address provided by your ISP.

Input the IP address of another DNS server if your ISP provides two DNS servers.

10. Maintenance

10.1 Firmware Update

To ensure our customers have the best user experience, we highly recommend you update to the newest version firmware.

❗ Keep the Puppis S1 connected to both the PC and the internet during the update. The Puppis S1 will restart after the update is completed.

● Method 1

- ❶ If a pop-up displays "Update Available" in the App, click "Update Firmware" to view the updated information.
- ❷ Click "Install" to download and install the new firmware.

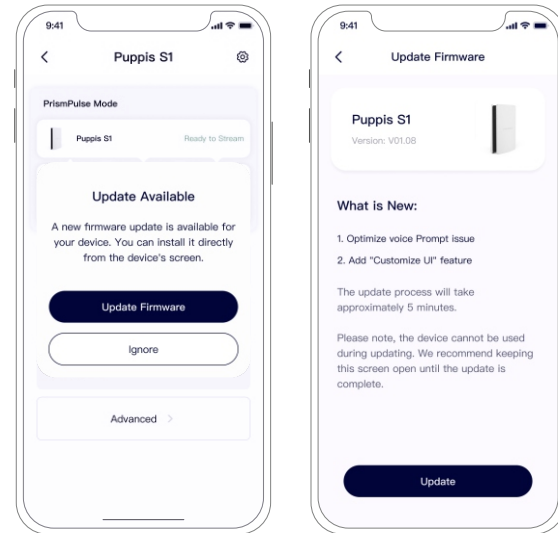

● Method 2

- ① Click "Settings" to enter the Settings page.
- ② Click "Firmware Version" to enter the "Update Firmware" page when there is a red dot.
- ③ Click "Install" to download and install the new firmware.

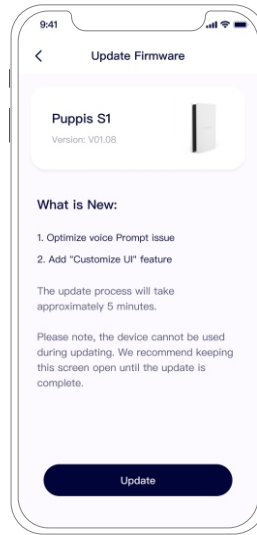
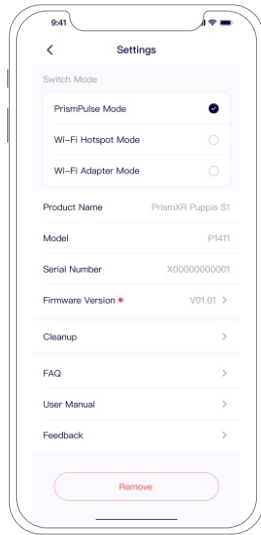
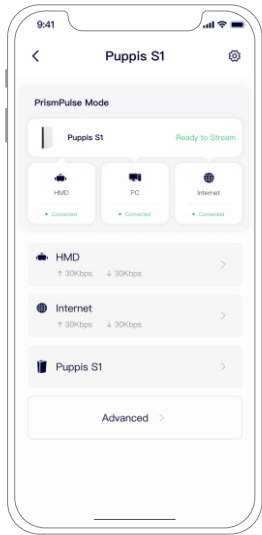

10.2 Factory Reset

- ❗ You might need to reset the Puppis S1 if you experience any connectivity problems or function issues.
 - ❗ Factory reset will erase all of your settings and restore it to factory defaults. After factory reset, your device will remain in your PrismXR App.
- 1 Press and hold the Reset button for 5 seconds until the three LED indicators flash red for 5 times.
 - 2 Puppis S1 will automatically restart after completing the factory reset.

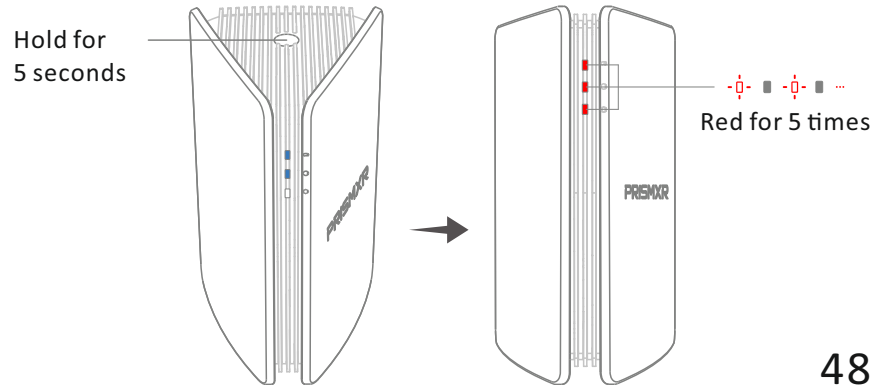

11. Specifications

WIRELESS

Wi-Fi Standards	Wi-Fi 6 IEEE 802.11 b/g/a/n/ac/ax
Wi-Fi bands	2412MHz ~ 2483.5MHz 5150MHz ~ 5250MHz 5250MHz ~ 5350MHz 5470MHz ~ 5725MHz 5725MHz ~ 5850MHz
Wi-Fi Speeds	5G: up to 2402Mbps 2.4G: up to 576Mbps
Features	MIMO, Beamforming, OFDMA
BLE	5.1 (For Moblie App)

HARDWARE

USB Ports	1*USB 3.2 Gen 1 (1000Mbps Ethernet)
------------------	-------------------------------------

Flash	1Gbits
DDR	2Gbits DDR3 2133Mbps
Buttons	1*Set Button, 1*Reset Button
LEDs	2*RGB LEDs, 1*RB LED
Power	5V = 3A

SOFTWARE

Working Modes	PrismPulse Mode Wi-Fi Hotspot Mode Wi-Fi Adapter Mode
Encryption	WPA PSK WPA2 PSK WPA3 PSK WPA PSK/WPA2 PSK WPA2 PSK/WPA3 PSK
Internet Protocol	Ipv4

Blacklists	Support
DHCP	DHCP Client DHCP Server
PrismXR App	Mode Setting, Network Monitor, Wireless Setting

OTHERS

System Requirements	Windows 11/10
Certifications	FCC
Certifications	Operating Temperature: 0°C~40°C (32°F ~104°F) Storage Temperature: -40°C~70°C (-40°F ~158°F) Operating Humidity: 10%~90% non-condensing Storage Humidity: 5%~90% non-condensing

PHYSICAL

Dimensions (W×D×H)	57.1 × 35.4 × 31.7 in (145 x 90 x 80.45mm)
---------------------------	--

12. Safety Instructions

The following basic guidelines are recommended when unpacking, installation, use, and maintenance of your electronic device.

- Avoid dropping.
- Do not disassemble.
- Do not use or install this product near water, to avoid fire or shock hazard. For example, near a bathtub, kitchen sink or laundry tub, or near a swimming pool. Also, do not expose the equipment to RAIN or MOISTURE areas (e.g. a wet basement).
- To safeguard the equipment against overheating, make sure that all openings in the unit that offer exposure to air are not blocked.
- Do not push any objects into the openings of your product. Doing so can cause fire or electric shock by shorting out interior components.
- Keep the product away from radiators and heat sources.

- Do not spill food or liquids on your product components.
- If your product uses a power adapter:
 - Make sure the USB adapter must meet the voltage and current marked on the product electrical ratings label.
 - Make sure that the ampere rating limit of the USB cable meet be fulfilled for the product.

13. Warranty

If you have any difficulties using your PrismXR Puppis S1, please contact us

Email: customerservice@prismxr.io

PRISMXR PTE LTD 60 PAYA LEBAR ROAD #12-03 PAYA LEBAR
SQUARE 409051

Warranty 18 months Limited Electrical Warranty

PrismXR warrants to the original residential user of this product that it will be free from defects in materials and workmanship, under normal use, for 18 months from the date of purchase. User must provide a copy of original purchase receipt. This warranty does not cover abuse or misused products or products used in commercial applications. This warranty does not apply to PrismXR Puppis S1 that have been improperly installed, modified, put to a use other than designed, or subjected to acts of God (such as floods, lightning, earthquakes, etc.). This warranty is limited to repair or replacement of the PrismXR Puppis S1 only at PrismXR's sole discretion. PrismXR will NOT be liable for the cost of installing, removing, nor reinstalling this product, nor direct, indirect, or consequential damages to persons or property resulting from the use of this product. This warranty only covers the cost of replacement parts or replacement units, it does not cover shipping & handling fees.

To implement this warranty, please visit www.prismxr.com/pages/support

14. FCC Statement

This device complies with Part 15 of the FCC Rules. Operation is subject to the following two conditions: (1) This device may not cause harmful interference, and (2) this device must accept any interference received, including interference that may cause undesired operation.

Warning: Changes or modifications not expressly approved by the party responsible for compliance could void the user's authority to operate the equipment.

Note: This equipment has been tested and found to comply with the limits for a Class B digital device, pursuant to Part 15 of the FCC Rules. These limits are designed to provide reasonable protection against harmful interference in a residential installation. This equipment generates, uses, and can radiate radio frequency energy and, if not installed and used in accordance with the instructions, may cause harmful interference to radio communications. However, there is no guarantee that interference will not occur in a particular installation. If this equipment does cause harmful interference to radio or television reception, which can be determined by turning the equipment off and on, the user is encouraged to try to correct the interference by one or more of the following measures:

- (1) Reorient or relocate the receiving antenna.
- (2) Increase the separation between the equipment and receiver.
- (3) Connect the equipment into an outlet on a circuit different from that to which the receiver is connected.
- (4) Consult the dealer or an experienced radio/TV technician for help.

To maintain compliance with FCC's RF exposure guidelines, this equipment should be installed and operated with a minimum distance of 20cm between the radiator and your body.

The following importer is the responsible party.

Company Name: PRISM XR PTE, LTD

Address: 60 PAYA LEBAR ROAD #12-03 PAYA LEBAR SQUARE SINGAPORE, 409051